

# magnum

[www.magnumbikes.com](http://www.magnumbikes.com)



**PLEASE READ ME FIRST!**

| Component  | Trademark | Model      |
|------------|-----------|------------|
| Controller | Das-Kit   | CT6        |
| Display    | Das-Kit   | C4         |
| Motor      | Das-Kit   | BFSWX02    |
| Battery    | Dehawk    | B1U-4813H  |
| Charger    | SANS      | SSLC109V55 |

## Introduction

We want to thank you for your purchase. This electric bicycle, equipped with pedals and an auxiliary electric motor, cannot be propelled exclusively by means the auxiliary electric motor. You will thoroughly enjoy riding this new, electrically assisted and folding bike.

Riding an e-bike means that you're helping preserve the environment, since you're not emitting any carbon or any other elements that pollute.

For your safety and for the safety of others, we recommend that you obey all road regulations and wear a protective helmet. For optimal, safe and enjoyable use of your e-bike, make sure you thoroughly read this user guide before you first use it.

**Have a pleasant ride!**

## General information:

Weight of bike without battery: 20.1 kg Maximum assistance speed: 25 km/h  
Brushless engine: 48V 250 W Multifunction display

Permissible weight of the rider: 100KG Maximum total weight: 120KG (includes the bike, the rider and the luggage)

## **Battery:**

Battery Weight: 4 kg

Lithium-ion 48V 13Ah

Charge time: 6.5

Range: between 40 and 88 km  
depending on the assistance level

## **Frame:**

Aluminum tubes, type 6061

## **Wheels:**

20" diameter (double chamber aluminum wheel)

## Turning On the Bicycle:

Turn on the battery by turning the key to the “ON” position

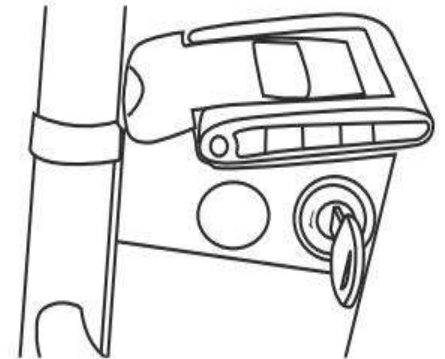

The 3 green LEDs located on top of the battery indicate its charge level.

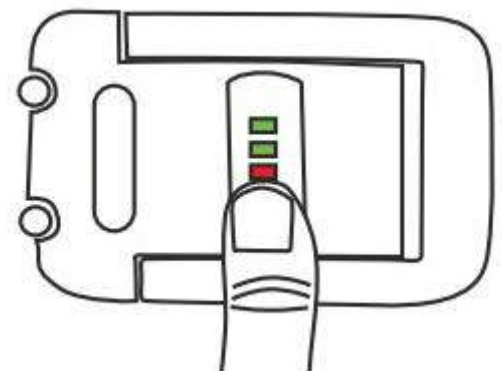

Turn on the display unit that is on the handlebars, select your desired assistance level and begin to pedal.

### **The engine starts as soon as you start pedaling!**

You can also use your bike without the electric assistance mode by turning off the battery (switching the key to OFF or by adjusting the assistance level on 0). The engine will then feature zero resistance: you'll be freewheeling. Select the appropriate gear by activating the 6-speed gear lever.

## **Brakes:**

When you use the brakes, the contactor located within these brakes immediately halt the engine's assistance.

The left brake lever controls the front brake. The right brake lever controls the rear brake. When using the brakes it is important to use both brakes at the same time as this will extend the lifetime of the brake pads and it will bring the bicycle to a faster stop.

**When only using the front wheel brake you must exercise caution to avoid flipping over!**

## Adjusting the height of the seat and handlebar-stem:

### Seat Height

Unlock the lever and adjust the seat height to the desired position **without ever exceeding the mark carved onto the seat's tube**. The seat's height must be set so that your leg is stretched out when the corresponding pedal is in the lower position. Once the correct height is set lock the lever.

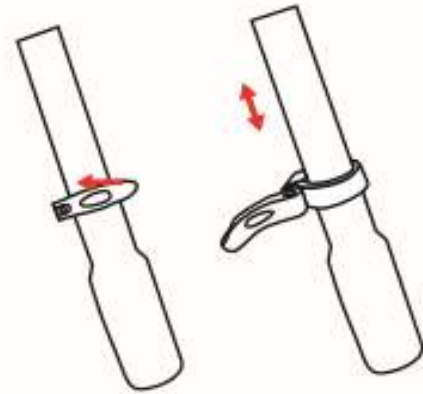

### Handlebar Height

Maximum comfort is usually obtained when the handlebar height is equal to the height of the seat. You may wish to try different heights to find the most comfortable position **without ever exceeding the mark carved onto the tube**.

## The Kickstand:

The bike is equipped with a lateral stand. Always prop up the bike on its stand on a flat and stable ground surface.

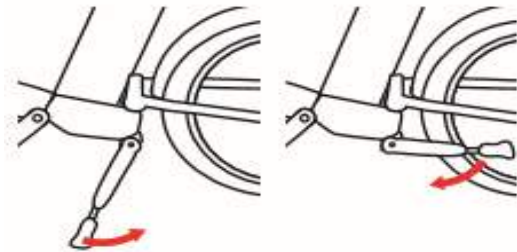

## Lights:

The front and rear light are battery operated and the power button is located on the light itself.

## Precautions required prior to each use:

Verify that the brakes and the front and rear lights are all working properly.

Verify the pressure of the tires (the correct PSI is listed on the side of each tire).

Make sure that the hinges on your bike are properly locked and that they do not require tightening.

This bike is not designed for rough usage, such as jumps, riding up or off of pavements, and riding on unpaved roads.

**For your own safety, no modifications may be made to the bike.**

**Please note: if you use your bike frequently, it is recommended that you inspect the state of the fork, the frame, the suspension and the fasteners. The materials and components may be subject to different reactions to usage and wear.**

If you have any doubts, contact your dealer, who will proceed with the necessary inspection.

## Folding the Bike

Folding the bicycle requires the following steps:

### 1. Folding the handlebars' shaft

Press the lock button to release the stem and fold the handlebar.

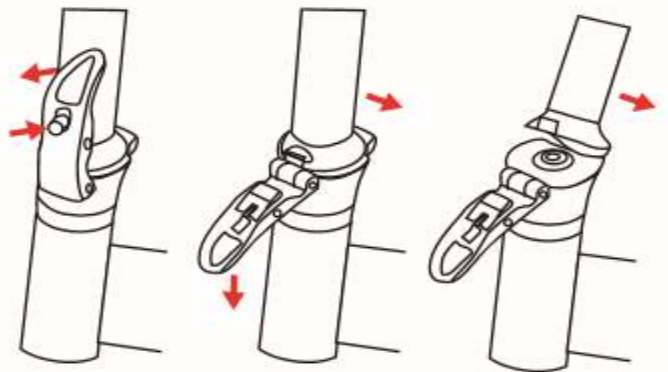

### 2. Folding the pedals

Press the pedal inward until it folds.

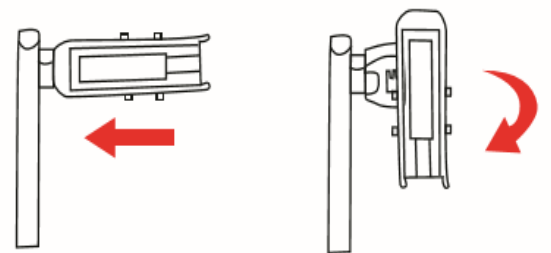

### 3. Folding the frame

Untighten the lever and free the hinge before removing the lever from its hinge and pulling it upward (You will then hear the safety hatch release itself). You can now open the hinge and fold the frame in half ... Your bike is now folded!

If you would like to ride the bike please reverse the above steps.

## The Battery

### Removing the battery

Lift up your seat as high as possible. Unlock the battery and remove the battery by pulling it upward. The battery must remain vertical. When you put the battery back into place, hold it all the way through. **Do not let it fall into its socket, otherwise you may damage the controller's sensors.**

### Charging the battery

Your battery must be charged in an ambient temperature, on a non-flammable and dry surface, away from any sources of heat, humidity or flammable materials. Also, it must not be covered. Here are the steps to be followed when charging your battery:

- Step 1.** Turn the battery off by switching the key to the OFF position.
- Step 2.** Plug the charger into a compatible wall socket
- Step 3.** Insert the charger plug into the battery

The charger's LED indicators lit up in the following manner:

- The red LED light is on: the battery is being charged.
- The red LED light is on: the battery is fully charged.

It takes 3-6 hours for the battery to be fully charged when using the standard charger that's supplied with your bike

## Battery safety instructions

The battery is an electric component made up of chemical elements. For your safety, it is imperative that you obey the following rules:

*Never store a completely discharged battery as it might result in permanent damage.*

*During the winter or long storage periods, it is recommended that you charge the battery halfway every 2 months. Don't forget to switch it off. Store your battery at a temperature between 15° and 25°.*

Always handle with great care and always keep it away from children

Do not take it apart or hit, pierce or submerge it

Keep it away from temperatures exceeding 60°

Never create a connection between the contacts located at the bottom of the battery

Never let the battery charge unattended

Only use an original charger that came with your bike or that was supplied by your dealer

If your battery is damaged, do not use it and take it back to your dealer as soon as possible

## 2. Function Display

### 2.1 FUNCTION SUMMARY

The indicated contents are as below.

